

LWDD Governing Board Meeting

March 12, 2025

Final Meeting Materials



Lake Worth Drainage District
PROCLAMATION

WHEREAS, the **LAKE WORTH DRAINAGE DISTRICT** is a vital political subdivision of the State of Florida, responsible for the ownership and management of more than 500 miles of drainage canals within its 200 square mile jurisdiction; and

WHEREAS, the **LAKE WORTH DRAINAGE DISTRICT** provides essential flood control, water conservation and water supply protection to nearly 1 million residents and thousands of acres of agricultural land through southeastern Palm Beach County; and

WHEREAS, **John I. Whitworth III** has honorably served as a Supervisor of the **LAKE WORTH DRAINAGE DISTRICT** since October 1990; demonstrating exceptional leadership, unwavering commitment, and invaluable expertise – greatly contributing to the District’s reputation as a model special district in the State of Florida; and

WHEREAS, throughout his tenure, **John I. Whitworth III** has been a steadfast guardian of the District’s canals and rights-of-way, fiercely protecting them against encroachments and advocating for their preservation as the area transitions from agricultural to residential use. Recognizing the region's ongoing growth—new neighborhoods, expanding roadways, and an increasing population—he has remained steadfast in his commitment to ensuring flood control and water supply remain a top priority. His leadership has reinforced the vital importance of these canals, which must continue to serve future generations as a crucial safeguard against flooding; and

WHEREAS, in recognition of his 35 years of dedicated service and with deep appreciation, the **LAKE WORTH DRAINAGE DISTRICT** and its Board of Supervisors, property owners, and employees seek to honor **John I. Whitworth III** by renaming the E-1 Equalizer Canal—the District’s westernmost canal spanning the entire north-south length of the District—as the **Whitworth Canal**.

NOW, THEREFORE BE IT RESOLVED, that the Board of Supervisors of the **LAKE WORTH DRAINAGE DISTRICT**, by unanimous consent, hereby adopts this proclamation, to be formally sealed and executed on this 12th day of March 2025.



A handwritten signature in black ink, appearing to read "S. Bedner", is written over a horizontal line.

Steve Bedner, President

Pine Tree Golf Club, Inc. request to install 280' L.F. of Culvert within the L-25 Canal

Project #RW-25-0049

Nicole Smith, Permit Supervisor
Board Meeting – March 12, 2025
Agenda Item #9



1

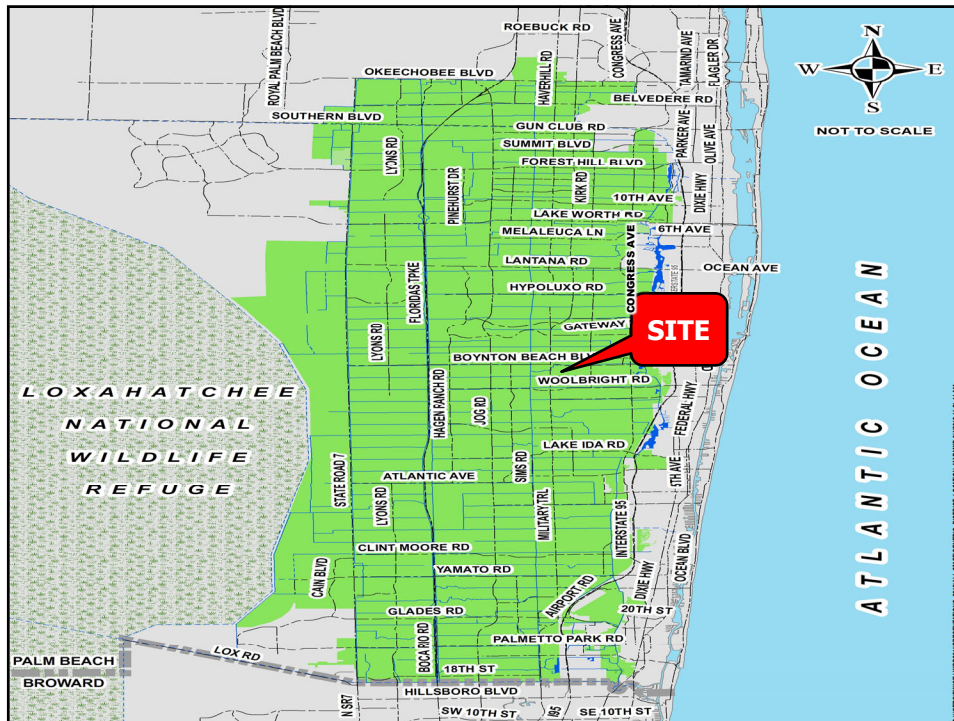

2

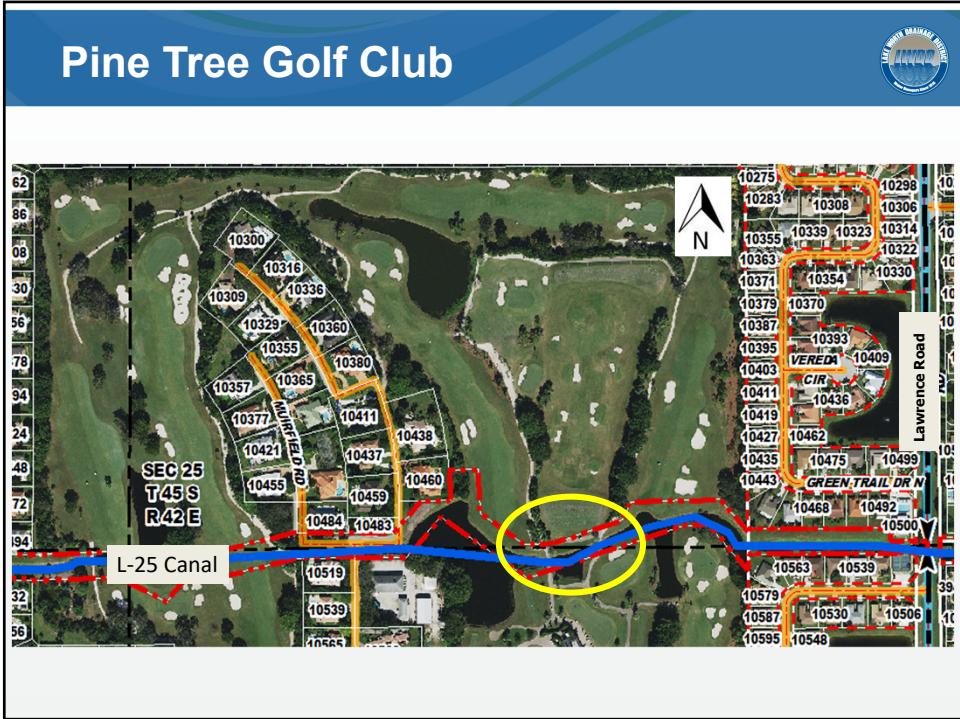

3

Project Information

- Pine Tree Golf Club is requesting to install ~280 L.F. of 72" RCP Culvert within the L-25 Canal to replace the two (2) existing Pedestrian Bridges located between Pine Tree Terrace and Lawrence Road

4

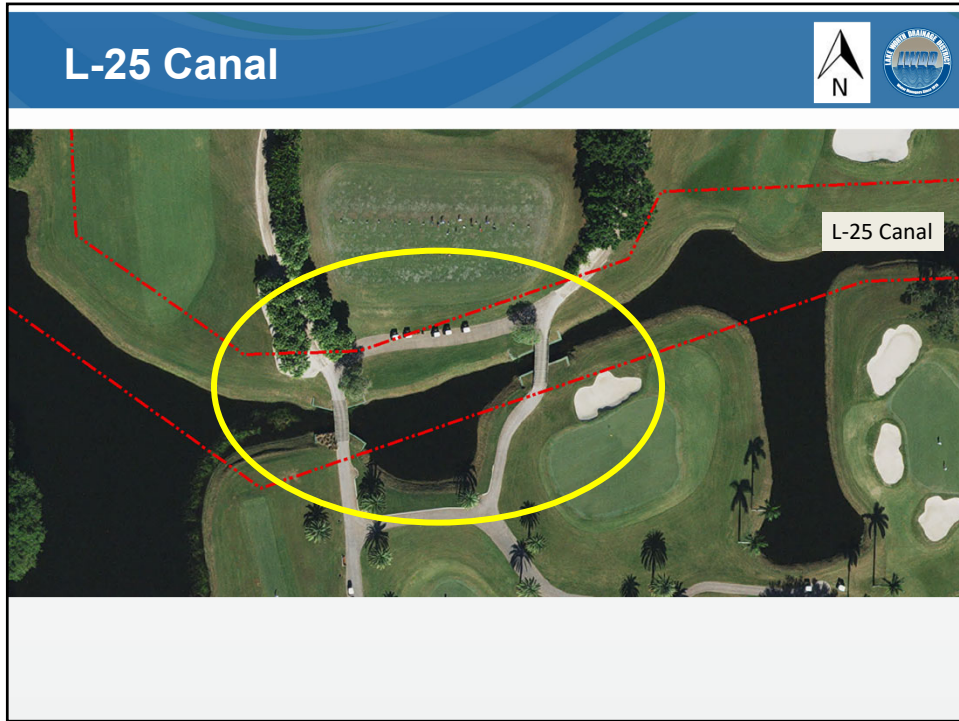

5

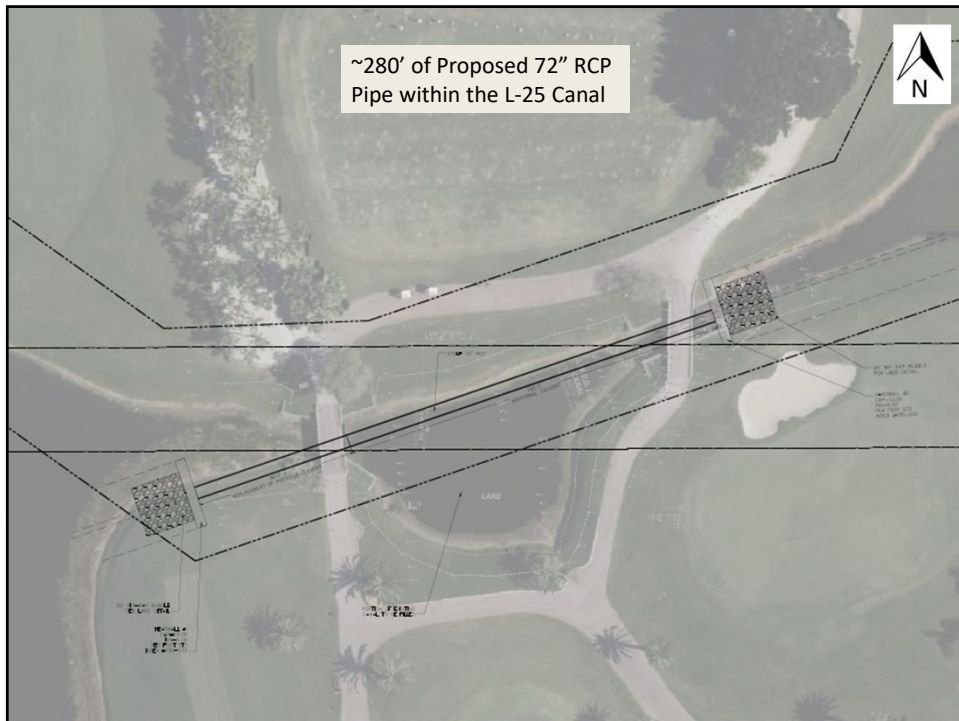

6

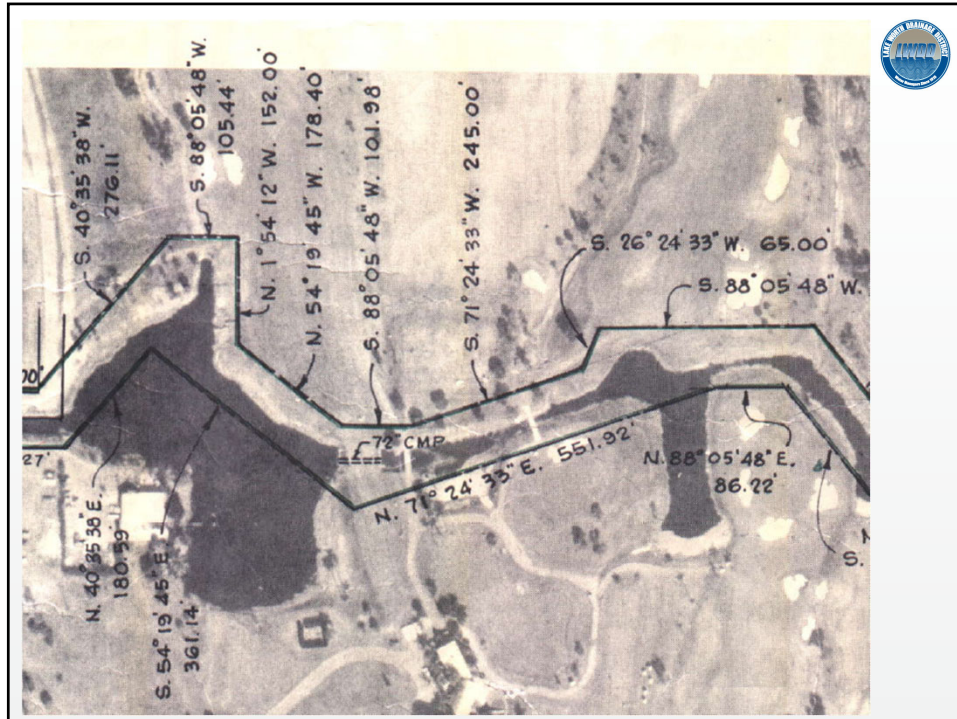

7

Policy

- LWDD will not consider approval to pipe a canal unless the applicant demonstrates a substantial hardship and provides reasonable assurances that drainage works and maintenance functions will not be harmed
- All requests to pipe a LWDD canal require approval by the Board of Supervisors

8

Assurances



- Pine Tree Golf Club proposal:
 - Install culvert to dimensions and specifications as identified by LWDD
 - Construct LWDD right-of-way access to design section throughout golf course
 - Exchange necessary right-of-way to ensure contiguous, unencumbered access
 - Contribute half of costs for repair of existing pipe located adjacent to Muirfield Road and the Joseph Property up to \$100K, to be paid upfront
 - Accept all future maintenance and financial responsibility to operate and maintain existing piped sections within Pine Tree, except roadway culvert crossings (HOA)
 - 5-Year inspections required on all culverts within Pine Tree Golf Club and Pine Tree HOA
 - Permit Fees:
 - Application Fee: \$2,520 (\$9.00 x 280 L.F.)
 - Use Fee: \$5,600.00 (\$20.00 x 280 L.F.)
 - Annual Fees: \$1,120.00 (\$4.00 x 280 L.F.) Adjusted every 5 years by the compounded Consumer Price Index (CPI)
 - Provide a Bond for construction/installation of proposed culvert and a Bond to insure future maintenance of culverts

9

Recommendation



- Approval of Applicant's request to install ~280 L.F. Culvert within the L-25 Canal to replace the two (2) existing Pedestrian Bridges located between Pine Tree Terrace and Lawrence Road, subject to:
 - All previous assurances
 - Staff approval of all plans, including but not limited to:
 - Engineering plans
 - Contingency drainage plan during construction
 - Complete golf course renovation plans
 - No additional culvert length to be approved in future
 - Removal of culvert if the Golf Course is no longer operational
- Board approval only grants staff authorization to issue the requested Right-of-Way Permit; does not grant approval of the permit until all conditions are met

10

Executive Director's Comments

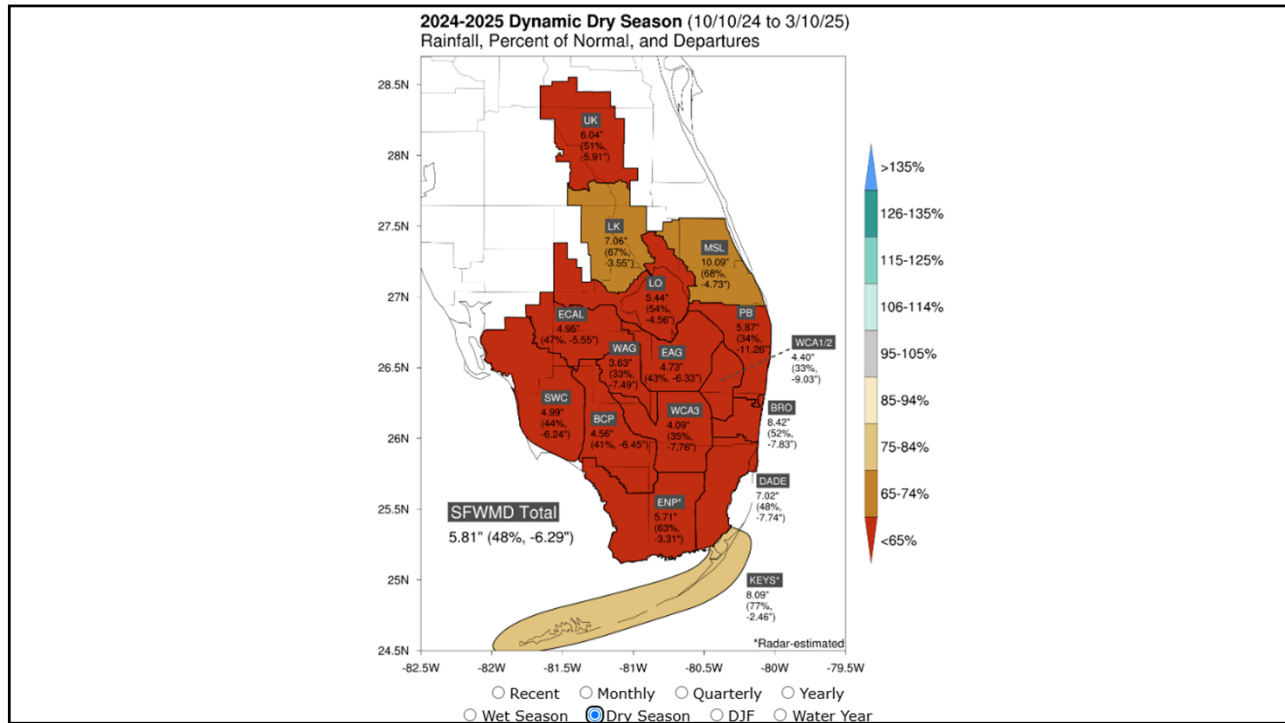

1

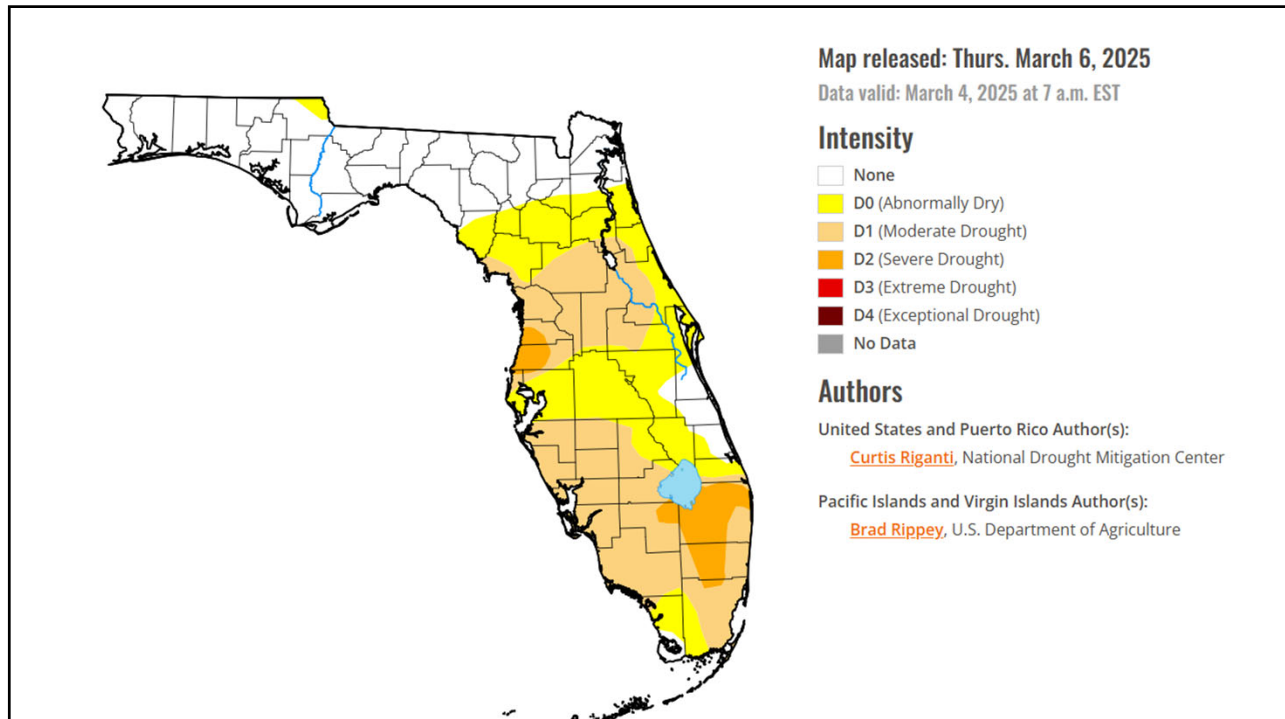

2

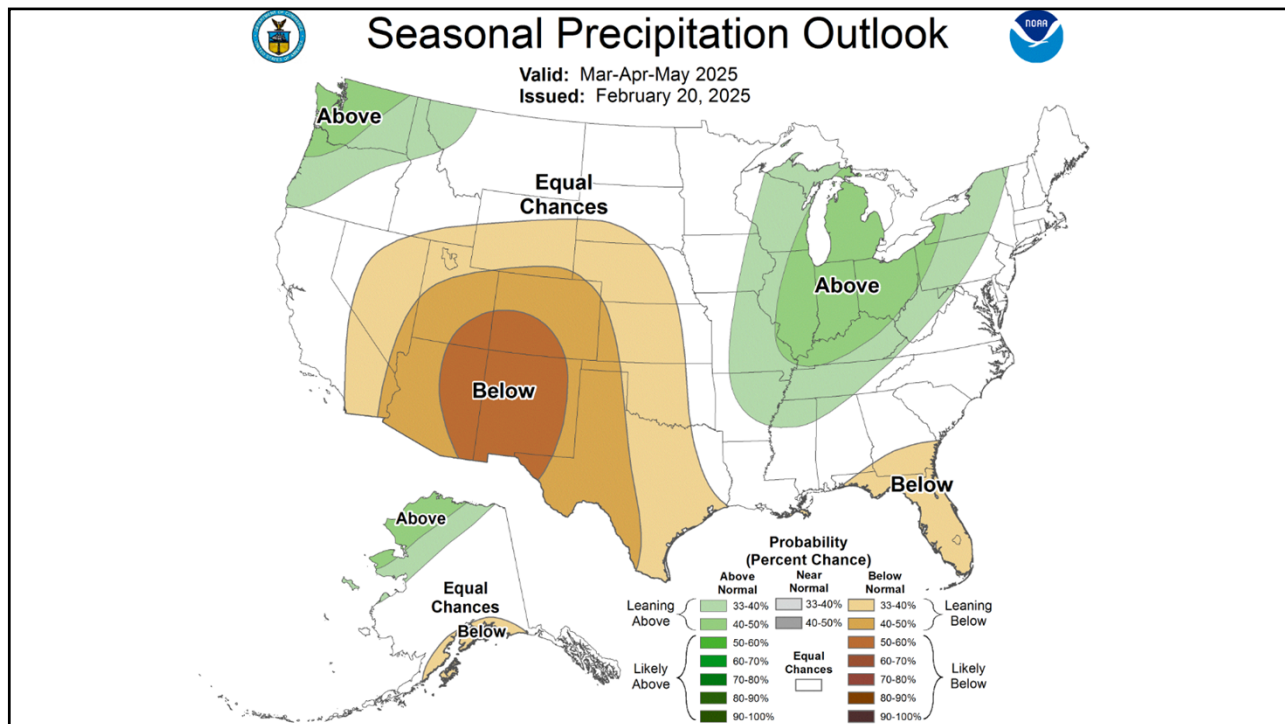

3

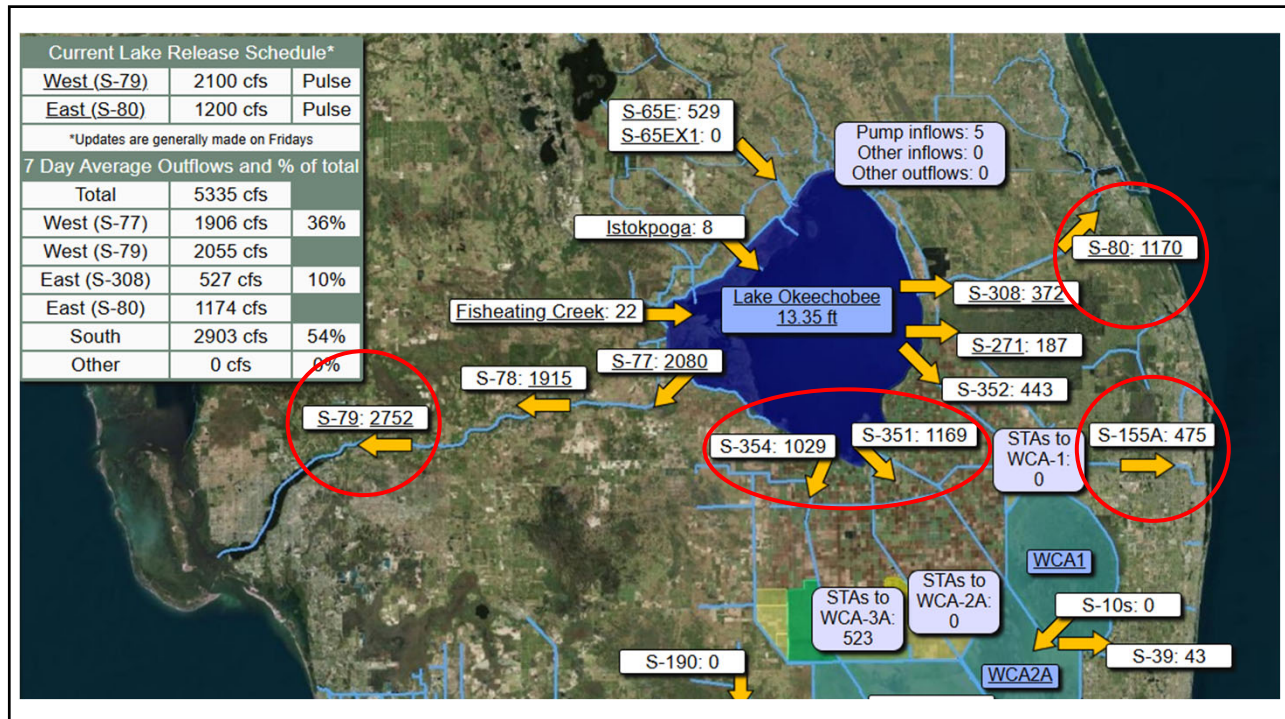

4

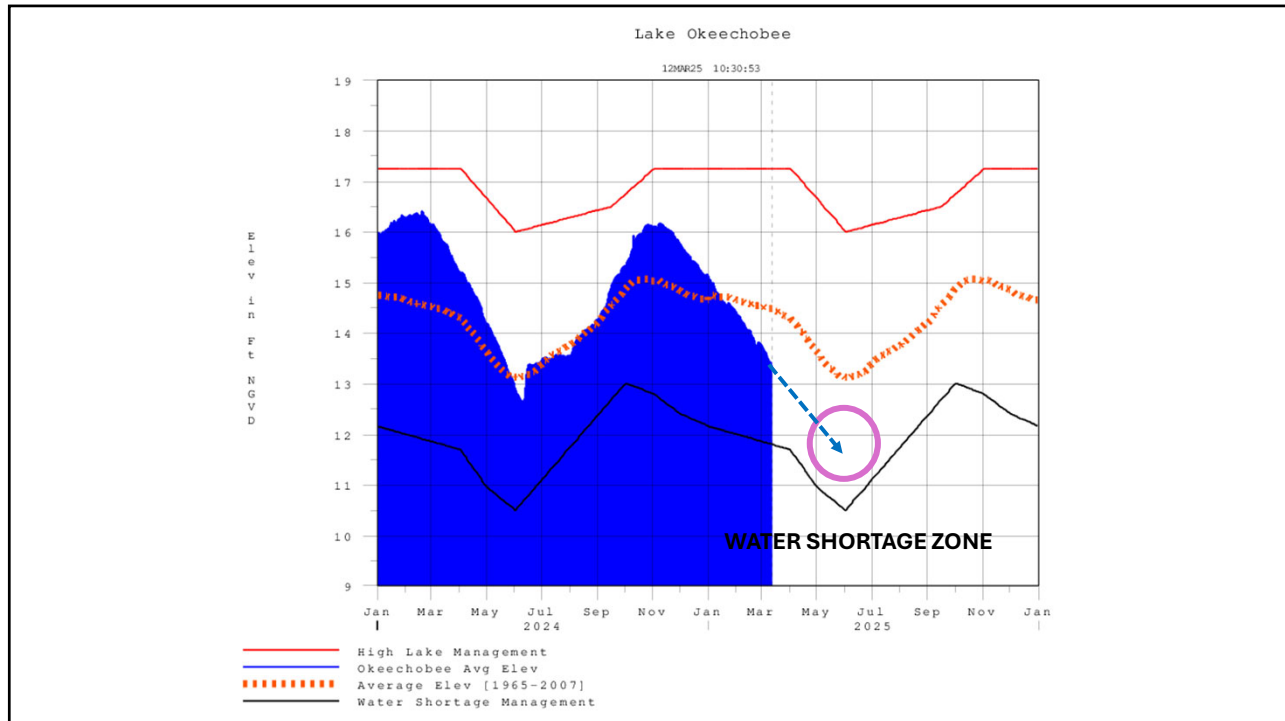

5

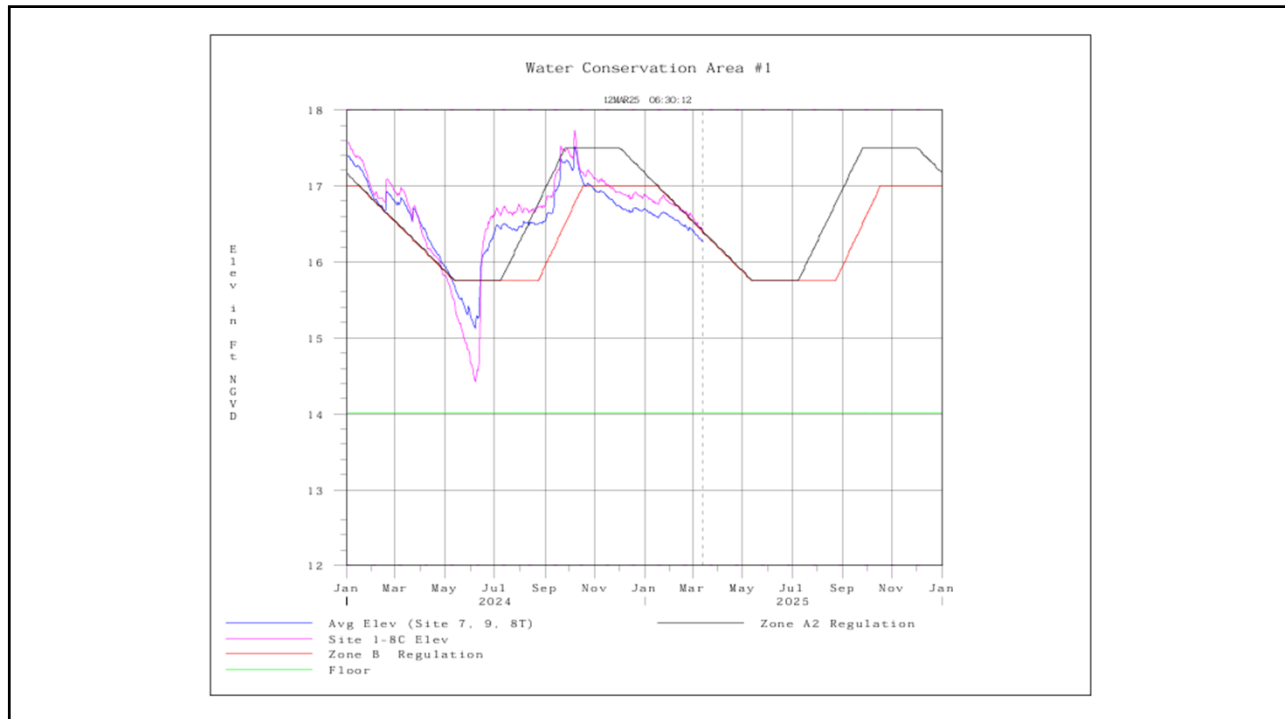

6

Florida DOGE Initiative Overview



- **Established by Executive Order 25-44**, effective February 24, 2025, to March 31, 2026.
- **Scope:** Review of agency & local government expenditures using public data
 - State Agencies,
 - University System,
 - Counties
 - Local Governments
 - Governor specifically mentioned cutting up to 70 State Boards and Commissions
 - **Special Taxing Districts *not specifically referenced***
- **Goal:** Cut unnecessary spending in state and local governments.
- **Method:** Primarily uses AI audits - Inspired by ongoing Federal efforts
- **Oversight:** EOG DOGE Team within the Governor's Office.
 - Requires DOGE Teams be established in each State Agency and report monthly to the EOG DOGE Team for 1-Year

7

Implications for Agencies & Local Governments



- **Legislative Changes Possible:** EOG DOGE Team to recommend legislative reforms by September 30, 2025,
- **Existing Oversight:** Florida has a separate Government Efficiency Task Force since 2007.
- Proactively review spending and ensure transparent financial reporting

8